

/ BROKK 130⁺



- Increased uptime and power over time
- Smart sensors and operator support system
- Lightweight control box with tilted joysticks
- 20,2 kW Brokk SmartPower+ electrical system
- Compatible with 16 A and 32 A fuses for flexible power options



The **Brokk 130⁺** sets a new benchmark in demolition, delivering more power, endurance, and efficiency than ever before. Designed for demanding environments, it combines high impact energy with intelligent power management, making it ideal for confined and hard-to-reach areas. With a 360-degree working radius, it ensures maximum flexibility in any operation.

Equipped with the BHB 175 breaker and the advanced Brokk SmartPower+ system, the **Brokk 130⁺** maximizes efficiency for superior demolition performance. It delivers 20% more hitting force and 40% higher impact frequency, boosting production by 40-60%. Every movement is precisely controlled for smoother operation, greater force, and optimized productivity.

TECHNICAL DATA

Slewing speed	10 sec/360°
Transport speed, max.	2.5 km/h; 1.6 mph
Climbing inclination, max.	30°
Hydraulic system capacity	40 l; 10.6 US gal
Pump type	Variable load-sensing
System pressure	18 MPa; 2611 psi
Pump flow 50 Hz	56 l/min; 14.8 US gal/min
60 Hz	66 l/min; 17.4 US gal/min
Power technology	Brokk SmartPower+
Electric motor type	ABB
Power*	20,2 kW
Recommended fuse size*	32 A
Minimum fuse size (reduced power)*	16 A
Starting device	Soft start
Control type	Portable
Signal code	Digital
Transfer	Professional radio/Cable
Range, radio	Up to 300 m
Machine weight**	990 kg; 2183 lbs
Recommended attachment weight	180 kg; 397 lbs
Sound power level L_{WA}***	91 dB(A)

*Valid for 400 V/50 Hz and 440 V/60 Hz

**Excluding options and attachment

***Measured according to directive 2000/14/EC, excl. attachment

OPTIONS

Extra cylinder protection

Rubber caterpillar tracks

Steel caterpillar tracks

Heat-resistant hoses

Forced draft cooling for machine

Forced draft cooling for breaker

Steel pads

Air flushing for breaker

Water spray for breaker

Extra hydraulic function

Drainage hose

CAN cable connection

Counterweight

Lifting eyes (regular lifting points are standard)

Extra support roller for rubber caterpillar tracks

Motion warning

Load holding valves

SIZE

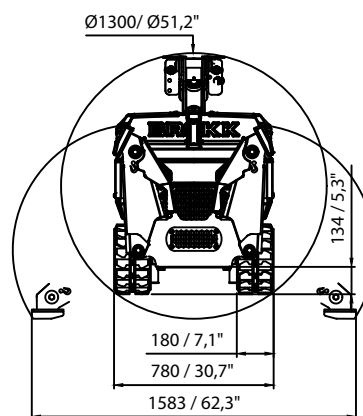
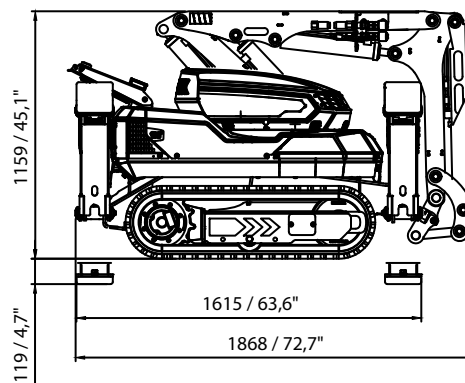

RANGE

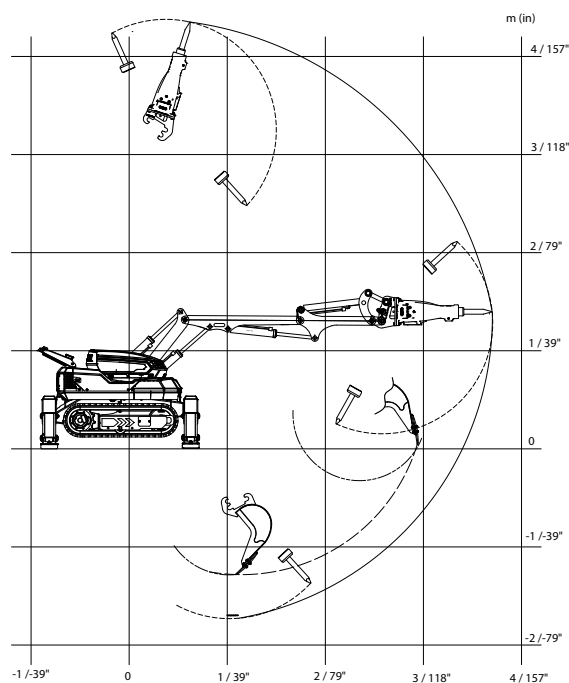

Tolerances for technical data may vary